

xEffect - Industrial Switchgear Range Miniature Circuit Breakers FAZT



Catalog



Powering Business Worldwide

SG56012



Description

FAZ-T

- High-quality miniature circuit breakers for industrial and commercial applications
- Contact position indicator red - green
- Accessories suitable for subsequent installation
- Rated currents up to 40 A
- Tripping characteristics B, C, D
- Rated breaking capacity up to 25 kA according to EN 60947-2
- Classified for the use in rail rolling stock

Rated current I_n (A)	Rated voltage acc. to IEC/EN 60898-1 (V)	Breaking capacity acc. to IEC/EN 60898-1 (kA)	Rated voltage acc. to IEC/EN 60947-2 (V)	Breaking capacity acc. to IEC/EN 60947-2 (kA)	Rated voltage acc. to IEC/EN 60947-2 (V)	Breaking capacity acc. to IEC/EN 60947-2 (kA)	Type Designation	Article No.	Units per package
----------------------------	------------------------------------------------------	--------------------------------------------------------------	------------------------------------------------------	--------------------------------------------------------------	------------------------------------------------------	--------------------------------------------------------------	---------------------	-------------	----------------------

Characteristic B

SG53212



1-pole

1	240	15	240	25	254	15	FAZT-B1/1	240770	12/120
2	240	15	240	25	254	15	FAZT-B2/1	240771	12/120
3	240	15	240	25	254	15	FAZT-B3/1	240772	12/120
4	240	15	240	25	254	15	FAZT-B4/1	240777	12/120
6	240	15	240	25	254	15	FAZT-B6/1	240782	12/120
10	240	15	240	25	254	15	FAZT-B10/1	240787	12/120
12	240	15	240	25	254	15	FAZT-B12/1	240792	12/120
13	240	15	240	25	254	15	FAZT-B13/1	240793	12/120
15	240	15	240	25	254	15	FAZT-B15/1	240794	12/120
16	240	15	240	25	254	15	FAZT-B16/1	240795	12/120
20	240	15	240	25	254	15	FAZT-B20/1	240796	12/120
25	240	15	240	25	254	15	FAZT-B25/1	240797	12/120
32	240	10	240	20	254	15	FAZT-B32/1	141907	12/120
40	240	10	240	20	254	15	FAZT-B40/1	141908	12/120

SG5412



1+N-poles

1	240	15	240	25	254	15	FAZT-B1/1N	240994	1/60
2	240	15	240	25	254	15	FAZT-B2/1N	240995	1/60
3	240	15	240	25	254	15	FAZT-B3/1N	240996	1/60
4	240	15	240	25	254	15	FAZT-B4/1N	240997	1/60
6	240	15	240	25	254	15	FAZT-B6/1N	240998	1/60
10	240	15	240	25	254	15	FAZT-B10/1N	240999	1/60
12	240	15	240	25	254	15	FAZT-B12/1N	241000	1/60
13	240	15	240	25	254	15	FAZT-B13/1N	241001	1/60
15	240	15	240	25	254	15	FAZT-B15/1N	241005	1/60
16	240	15	240	25	254	15	FAZT-B16/1N	241009	1/60
20	240	15	240	25	254	15	FAZT-B20/1N	241015	1/60
25	240	15	240	25	254	15	FAZT-B25/1N	241019	1/60
32	240	10	240	20	254	15	FAZT-B32/1N	142509	1/60
40	240	10	240	20	254	15	FAZT-B40/1N	142510	1/60

SG55212



2-poles

1	415	15	240/415	25	254/440	15	FAZT-B1/2	240820	1/60
2	415	15	240/415	25	254/440	15	FAZT-B2/2	240821	1/60
3	415	15	240/415	25	254/440	15	FAZT-B3/2	240822	1/60
4	415	15	240/415	25	254/440	15	FAZT-B4/2	240823	1/60
6	415	15	240/415	25	254/440	15	FAZT-B6/2	240824	1/60
10	415	15	240/415	25	254/440	15	FAZT-B10/2	240825	1/60
12	415	15	240/415	25	254/440	15	FAZT-B12/2	240826	1/60
13	415	15	240/415	25	254/440	15	FAZT-B13/2	240827	1/60
15	415	15	240/415	25	254/440	15	FAZT-B15/2	240828	1/60
16	415	15	240/415	25	254/440	15	FAZT-B16/2	240829	1/60
20	415	15	240/415	25	254/440	15	FAZT-B20/2	240830	1/60
25	415	15	240/415	25	254/440	15	FAZT-B25/2	240831	1/60
32	415	10	240/415	20	254/440	15	FAZT-B32/2	142485	1/60
40	415	10	240/415	20	254/440	15	FAZT-B40/2	142486	1/60

1.3

Miniature Circuit Breakers

xEffect

FAZ-T Miniature Circuit Breakers

Rated current I_n (A)	Rated voltage acc. to IEC/EN 60898-1 (V)	Breaking capacity acc. to IEC/EN 60898-1 (kA)	Rated voltage acc. to IEC/EN 60947-2 (V)	Breaking capacity acc. to IEC/EN 60947-2 (kA)	Rated voltage acc. to IEC/EN 60947-2 (V)	Breaking capacity acc. to IEC/EN 60947-2 (kA)	Type Designation	Article No.	Units per package
----------------------------	------------------------------------------------------	--------------------------------------------------------------	------------------------------------------------------	--------------------------------------------------------------	------------------------------------------------------	--------------------------------------------------------------	---------------------	-------------	----------------------

SG53512



3-poles

1	415	15	240/415	25	254/440	15	FAZT-B1/3	240874	1/40
2	415	15	240/415	25	254/440	15	FAZT-B2/3	240875	1/40
3	415	15	240/415	25	254/440	15	FAZT-B3/3	240876	1/40
4	415	15	240/415	25	254/440	15	FAZT-B4/3	240877	1/40
6	415	15	240/415	25	254/440	15	FAZT-B6/3	240878	1/40
10	415	15	240/415	25	254/440	15	FAZT-B10/3	240879	1/40
12	415	15	240/415	25	254/440	15	FAZT-B12/3	240880	1/40
13	415	15	240/415	25	254/440	15	FAZT-B13/3	240881	1/40
15	415	15	240/415	25	254/440	15	FAZT-B15/3	240882	1/40
16	415	15	240/415	25	254/440	15	FAZT-B16/3	240883	1/40
20	415	15	240/415	25	254/440	15	FAZT-B20/3	240884	1/40
25	415	15	240/415	25	254/440	15	FAZT-B25/3	240885	1/40
32	415	10	240/415	20	254/440	15	FAZT-B32/3	142493	1/40
40	415	10	240/415	20	254/440	15	FAZT-B40/3	142494	1/40

SG55912



3+N-poles

1	415	15	240/415	25	254/440	15	FAZT-B1/3N	241060	1/30
2	415	15	240/415	25	254/440	15	FAZT-B2/3N	241065	1/30
3	415	15	240/415	25	254/440	15	FAZT-B3/3N	241070	1/30
4	415	15	240/415	25	254/440	15	FAZT-B4/3N	241075	1/30
6	415	15	240/415	25	254/440	15	FAZT-B6/3N	241080	1/30
10	415	15	240/415	25	254/440	15	FAZT-B10/3N	241085	1/30
12	415	15	240/415	25	254/440	15	FAZT-B12/3N	241090	1/30
13	415	15	240/415	25	254/440	15	FAZT-B13/3N	241095	1/30
15	415	15	240/415	25	254/440	15	FAZT-B15/3N	241100	1/30
16	415	15	240/415	25	254/440	15	FAZT-B16/3N	241105	1/30
20	415	15	240/415	25	254/440	15	FAZT-B20/3N	241110	1/30
25	415	15	240/415	25	254/440	15	FAZT-B25/3N	241115	1/30
32	415	10	240/415	20	254/440	15	FAZT-B32/3N	142517	1/30
40	415	10	240/415	20	254/440	15	FAZT-B40/3N	142518	1/30

SG56012



4-poles

1	415	15	240/415	25	254/440	15	FAZT-B1/4	240922	1/30
2	415	15	240/415	25	254/440	15	FAZT-B2/4	240927	1/30
3	415	15	240/415	25	254/440	15	FAZT-B3/4	240930	1/30
4	415	15	240/415	25	254/440	15	FAZT-B4/4	240931	1/30
6	415	15	240/415	25	254/440	15	FAZT-B6/4	240932	1/30
10	415	15	240/415	25	254/440	15	FAZT-B10/4	240933	1/30
12	415	15	240/415	25	254/440	15	FAZT-B12/4	240934	1/30
13	415	15	240/415	25	254/440	15	FAZT-B13/4	240935	1/30
15	415	15	240/415	25	254/440	15	FAZT-B15/4	240936	1/30
16	415	15	240/415	25	254/440	15	FAZT-B16/4	240937	1/30
20	415	15	240/415	25	254/440	15	FAZT-B20/4	240938	1/30
25	415	15	240/415	25	254/440	15	FAZT-B25/4	240939	1/30
32	415	10	240/415	20	254/440	15	FAZT-B32/4	142501	1/30
40	415	10	240/415	20	254/440	15	FAZT-B40/4	142502	1/30

Rated current I_n (A)	Rated voltage acc. to IEC/EN 60898-1 (V)	Breaking capacity acc. to IEC/EN 60898-1 (kA)	Rated voltage acc. to IEC/EN 60947-2 (V)	Breaking capacity acc. to IEC/EN 60947-2 (kA)	Rated voltage acc. to IEC/EN 60947-2 (V)	Breaking capacity acc. to IEC/EN 60947-2 (kA)	Type Designation	Article No.	Units per package
----------------------------	------------------------------------------------------	--------------------------------------------------------------	------------------------------------------------------	--------------------------------------------------------------	------------------------------------------------------	--------------------------------------------------------------	---------------------	-------------	----------------------

Characteristic C

SG53212



1-pole

1	240	15	240	25	254	15	FAZT-C1/1	240798	12/120
2	240	15	240	25	254	15	FAZT-C2/1	240799	12/120
3	240	15	240	25	254	15	FAZT-C3/1	240800	12/120
4	240	15	240	25	254	15	FAZT-C4/1	240801	12/120
6	240	15	240	25	254	15	FAZT-C6/1	240802	12/120
10	240	15	240	25	254	15	FAZT-C10/1	240803	12/120
12	240	15	240	25	254	15	FAZT-C12/1	240804	12/120
13	240	15	240	25	254	15	FAZT-C13/1	240805	12/120
15	240	15	240	25	254	15	FAZT-C15/1	240806	12/120
16	240	15	240	25	254	15	FAZT-C16/1	240807	12/120
20	240	15	240	25	254	15	FAZT-C20/1	240808	12/120
25	240	15	240	25	254	15	FAZT-C25/1	240809	12/120
32	240	10	240	20	254	15	FAZT-C32/1	141909	12/120
40	240	10	240	20	254	15	FAZT-C40/1	142480	12/120

SG5412



1+N-poles

1	240	15	240	25	254	15	FAZT-C1/1N	241022	1/60
2	240	15	240	25	254	15	FAZT-C2/1N	241023	1/60
3	240	15	240	25	254	15	FAZT-C3/1N	241024	1/60
4	240	15	240	25	254	15	FAZT-C4/1N	241025	1/60
6	240	15	240	25	254	15	FAZT-C6/1N	241026	1/60
10	240	15	240	25	254	15	FAZT-C10/1N	241027	1/60
12	240	15	240	25	254	15	FAZT-C12/1N	241028	1/60
13	240	15	240	25	254	15	FAZT-C13/1N	241029	1/60
15	240	15	240	25	254	15	FAZT-C15/1N	241030	1/60
16	240	15	240	25	254	15	FAZT-C16/1N	241034	1/60
20	240	15	240	25	254	15	FAZT-C20/1N	241038	1/60
25	240	15	240	25	254	15	FAZT-C25/1N	241044	1/60
32	240	10	240	20	254	15	FAZT-C32/1N	142511	1/60
40	240	10	240	20	254	15	FAZT-C40/1N	142512	1/60

SG55212



2-poles

1	415	15	240/415	25	254/440	15	FAZT-C1/2	240832	1/60
2	415	15	240/415	25	254/440	15	FAZT-C2/2	240833	1/60
3	415	15	240/415	25	254/440	15	FAZT-C3/2	240838	1/60
4	415	15	240/415	25	254/440	15	FAZT-C4/2	240843	1/60
6	415	15	240/415	25	254/440	15	FAZT-C6/2	240850	1/60
10	415	15	240/415	25	254/440	15	FAZT-C10/2	240855	1/60
12	415	15	240/415	25	254/440	15	FAZT-C12/2	240858	1/60
13	415	15	240/415	25	254/440	15	FAZT-C13/2	240859	1/60
15	415	15	240/415	25	254/440	15	FAZT-C15/2	240860	1/60
16	415	15	240/415	25	254/440	15	FAZT-C16/2	240861	1/60
20	415	15	240/415	25	254/440	15	FAZT-C20/2	240862	1/60
25	415	15	240/415	25	254/440	15	FAZT-C25/2	240863	1/60
32	415	10	240/415	20	254/440	15	FAZT-C32/2	142487	1/60
40	415	10	240/415	20	254/440	15	FAZT-C40/2	142488	1/60

FAZ-T Miniature Circuit Breakers

Rated current I_n (A)	Rated voltage acc. to IEC/EN 60898-1 (V)	Breaking capacity acc. to IEC/EN 60898-1 (kA)	Rated voltage acc. to IEC/EN 60947-2 (V)	Breaking capacity acc. to IEC/EN 60947-2 (kA)	Rated voltage acc. to IEC/EN 60947-2 (V)	Breaking capacity acc. to IEC/EN 60947-2 (kA)	Type Designation	Article No.	Units per package
----------------------------	------------------------------------------------------	--------------------------------------------------------------	------------------------------------------------------	--------------------------------------------------------------	------------------------------------------------------	--------------------------------------------------------------	---------------------	-------------	----------------------

SG53512



3-poles

1	415	15	240/415	25	254/440	15	FAZT-C1/3	240886	1/40
2	415	15	240/415	25	254/440	15	FAZT-C2/3	240887	1/40
3	415	15	240/415	25	254/440	15	FAZT-C3/3	240888	1/40
4	415	15	240/415	25	254/440	15	FAZT-C4/3	240889	1/40
6	415	15	240/415	25	254/440	15	FAZT-C6/3	240890	1/40
10	415	15	240/415	25	254/440	15	FAZT-C10/3	240891	1/40
12	415	15	240/415	25	254/440	15	FAZT-C12/3	240892	1/40
13	415	15	240/415	25	254/440	15	FAZT-C13/3	240893	1/40
15	415	15	240/415	25	254/440	15	FAZT-C15/3	240894	1/40
16	415	15	240/415	25	254/440	15	FAZT-C16/3	240895	1/40
20	415	15	240/415	25	254/440	15	FAZT-C20/3	240896	1/40
25	415	15	240/415	25	254/440	15	FAZT-C25/3	240897	1/40
32	415	10	240/415	20	254/440	15	FAZT-C32/3	142495	1/40
40	415	10	240/415	20	254/440	15	FAZT-C40/3	142496	1/40

SG55912



3+N-poles

1	415	15	240/415	25	254/440	15	FAZT-C1/3N	241120	1/30
2	415	15	240/415	25	254/440	15	FAZT-C2/3N	241125	1/30
3	415	15	240/415	25	254/440	15	FAZT-C3/3N	241130	1/30
4	415	15	240/415	25	254/440	15	FAZT-C4/3N	241135	1/30
6	415	15	240/415	25	254/440	15	FAZT-C6/3N	241140	1/30
10	415	15	240/415	25	254/440	15	FAZT-C10/3N	241145	1/30
12	415	15	240/415	25	254/440	15	FAZT-C12/3N	241150	1/30
13	415	15	240/415	25	254/440	15	FAZT-C13/3N	241155	1/30
15	415	15	240/415	25	254/440	15	FAZT-C15/3N	241160	1/30
16	415	15	240/415	25	254/440	15	FAZT-C16/3N	241165	1/30
20	415	15	240/415	25	254/440	15	FAZT-C20/3N	241170	1/30
25	415	15	240/415	25	254/440	15	FAZT-C25/3N	241175	1/30
32	415	10	240/415	20	254/440	15	FAZT-C32/3N	142519	1/30
40	415	10	240/415	20	254/440	15	FAZT-C40/3N	142520	1/30

SG56012



4-poles

1	415	15	240/415	25	254/440	15	FAZT-C1/4	240940	1/30
2	415	15	240/415	25	254/440	15	FAZT-C2/4	240941	1/30
3	415	15	240/415	25	254/440	15	FAZT-C3/4	240945	1/30
4	415	15	240/415	25	254/440	15	FAZT-C4/4	240949	1/30
6	415	15	240/415	25	254/440	15	FAZT-C6/4	240955	1/30
10	415	15	240/415	25	254/440	15	FAZT-C10/4	240959	1/30
12	415	15	240/415	25	254/440	15	FAZT-C12/4	240962	1/30
13	415	15	240/415	25	254/440	15	FAZT-C13/4	240963	1/30
15	415	15	240/415	25	254/440	15	FAZT-C15/4	240964	1/30
16	415	15	240/415	25	254/440	15	FAZT-C16/4	240965	1/30
20	415	15	240/415	25	254/440	15	FAZT-C20/4	240966	1/30
25	415	15	240/415	25	254/440	15	FAZT-C25/4	240967	1/30
32	415	10	240/415	20	254/440	15	FAZT-C32/4	142503	1/30
40	415	10	240/415	20	254/440	15	FAZT-C40/4	142504	1/30

Rated current I_n (A)	Rated voltage acc. to IEC/EN 60898-1 (V)	Breaking capacity acc. to IEC/EN 60898-1 (kA)	Rated voltage acc. to IEC/EN 60947-2 (V)	Breaking capacity acc. to IEC/EN 60947-2 (kA)	Type Designation	Article No.	Units per package
----------------------------	------------------------------------------------------	--------------------------------------------------------------	------------------------------------------------------	--------------------------------------------------------------	---------------------	-------------	----------------------

Characteristic D

SG53212



1-pole

1	240	15	240	25	FAZT-D1/1	240810	12/120
2	240	15	240	25	FAZT-D2/1	240811	12/120
3	240	15	240	25	FAZT-D3/1	240812	12/120
4	240	15	240	25	FAZT-D4/1	240813	12/120
6	240	15	240	25	FAZT-D6/1	240814	12/120
10	240	15	240	25	FAZT-D10/1	240815	12/120
12	240	15	240	25	FAZT-D12/1	240816	12/120
13	240	15	240	25	FAZT-D13/1	240817	12/120
15	240	15	240	20	FAZT-D15/1	240818	12/120
16	240	15	240	20	FAZT-D16/1	240819	12/120
20	240	10	240	20	FAZT-D20/1	142481	12/120
25	240	10	240	15	FAZT-D25/1	142482	12/120
32	240	10	240	15	FAZT-D32/1	142483	12/120
40	240	10	240	15	FAZT-D40/1	142484	12/120

SG5412



1+N-poles

1	240	15	240	25	FAZT-D1/1N	241048	1/60
2	240	15	240	25	FAZT-D2/1N	241051	1/60
3	240	15	240	25	FAZT-D3/1N	241052	1/60
4	240	15	240	25	FAZT-D4/1N	241053	1/60
6	240	15	240	25	FAZT-D6/1N	241054	1/60
10	240	15	240	25	FAZT-D10/1N	241055	1/60
12	240	15	240	25	FAZT-D12/1N	241056	1/60
13	240	15	240	25	FAZT-D13/1N	241057	1/60
15	240	15	240	20	FAZT-D15/1N	241058	1/60
16	240	15	240	20	FAZT-D16/1N	241059	1/60
20	240	10	240	20	FAZT-D20/1N	142513	1/60
25	240	10	240	15	FAZT-D25/1N	142514	1/60
32	240	10	240	15	FAZT-D32/1N	142515	1/60
40	240	10	240	15	FAZT-D40/1N	142516	1/60

SG55212



2-poles

1	415	15	240/415	25	FAZT-D1/2	240864	1/60
2	415	15	240/415	25	FAZT-D2/2	240865	1/60
3	415	15	240/415	25	FAZT-D3/2	240866	1/60
4	415	15	240/415	25	FAZT-D4/2	240867	1/60
6	415	15	240/415	25	FAZT-D6/2	240868	1/60
10	415	15	240/415	25	FAZT-D10/2	240869	1/60
12	415	15	240/415	25	FAZT-D12/2	240870	1/60
13	415	15	240/415	25	FAZT-D13/2	240871	1/60
15	415	15	240/415	20	FAZT-D15/2	240872	1/60
16	415	15	240/415	20	FAZT-D16/2	240873	1/60
20	415	10	240/415	20	FAZT-D20/2	142489	1/60
25	415	10	240/415	15	FAZT-D25/2	142490	1/60
32	415	10	240/415	15	FAZT-D32/2	142491	1/60
40	415	10	240/415	15	FAZT-D40/2	142492	1/60

FAZ-T Miniature Circuit Breakers

Rated current I_n (A)	Rated voltage acc. to IEC/EN 60898-1 (V)	Breaking capacity acc. to IEC/EN 60898-1 (kA)	Rated voltage acc. to IEC/EN 60947-2 (V)	Breaking capacity acc. to IEC/EN 60947-2 (kA)	Type Designation	Article No.	Units per package
----------------------------	------------------------------------------------------	--------------------------------------------------------------	------------------------------------------------------	--------------------------------------------------------------	---------------------	-------------	----------------------

SG55612



3-poles

1	415	15	240/415	25	FAZT-D1/3	240898	1/40
2	415	15	240/415	25	FAZT-D2/3	240899	1/40
3	415	15	240/415	25	FAZT-D3/3	240900	1/40
4	415	15	240/415	25	FAZT-D4/3	240901	1/40
6	415	15	240/415	25	FAZT-D6/3	240902	1/40
10	415	15	240/415	25	FAZT-D10/3	240903	1/40
12	415	15	240/415	25	FAZT-D12/3	240904	1/40
13	415	15	240/415	25	FAZT-D13/3	240905	1/40
15	415	15	240/415	25	FAZT-D15/3	240910	1/40
16	415	15	240/415	25	FAZT-D16/3	240915	1/40
20	415	10	240/415	20	FAZT-D20/3	142497	1/40
25	415	10	240/415	15	FAZT-D25/3	142498	1/40
32	415	10	240/415	15	FAZT-D32/3	142499	1/40
40	415	10	240/415	15	FAZT-D40/3	142500	1/40

SG55912



3+N-poles

1	415	15	240/415	25	FAZT-D1/3N	241180	1/30
2	415	15	240/415	25	FAZT-D2/3N	241181	1/30
3	415	15	240/415	25	FAZT-D3/3N	241182	1/30
4	415	15	240/415	25	FAZT-D4/3N	241183	1/30
6	415	15	240/415	25	FAZT-D6/3N	241184	1/30
10	415	15	240/415	25	FAZT-D10/3N	241185	1/30
12	415	15	240/415	25	FAZT-D12/3N	241186	1/30
13	415	15	240/415	25	FAZT-D13/3N	241187	1/30
15	415	15	240/415	25	FAZT-D15/3N	241188	1/30
16	415	15	240/415	25	FAZT-D16/3N	241189	1/30
20	415	10	240/415	20	FAZT-D20/3N	142521	1/30
25	415	10	240/415	15	FAZT-D25/3N	142522	1/30
32	415	10	240/415	15	FAZT-D32/3N	142523	1/30
40	415	10	240/415	15	FAZT-D40/3N	142524	1/30

SG56012



4-poles

1	415	15	240/415	25	FAZT-D1/4	240968	1/30
2	415	15	240/415	25	FAZT-D2/4	240969	1/30
3	415	15	240/415	25	FAZT-D3/4	240970	1/30
4	415	15	240/415	25	FAZT-D4/4	240971	1/30
6	415	15	240/415	25	FAZT-D6/4	240975	1/30
10	415	15	240/415	25	FAZT-D10/4	240979	1/30
12	415	15	240/415	25	FAZT-D12/4	240985	1/30
13	415	15	240/415	25	FAZT-D13/4	240989	1/30
15	415	15	240/415	25	FAZT-D15/4	240992	1/30
16	415	15	240/415	25	FAZT-D16/4	240993	1/30
20	415	10	240/415	20	FAZT-D20/4	142505	1/30
25	415	10	240/415	15	FAZT-D25/4	142506	1/30
32	415	10	240/415	15	FAZT-D32/4	142507	1/30
40	415	10	240/415	15	FAZT-D40/4	142508	1/30

Technical Data

		FAZ-T
Productstandard		IEC/EN 60947-2, IEC/EN 60898-1
Classified according to		IEC 61373, EN 45545-2
Current test marks as printed onto the device		
Number of poles		1, 1p+N, 2, 3, 3p+N, 4
Mechanical		
Device width		17.7 mm (1p), 27 mm (1p+N), 36 mm (2p), 54 mm (3p), 72 mm (3p+N), 72 mm (4p)
Frame size		45 mm
Device height		80 mm
Device depth		60 mm
Terminals		lift terminal
Terminal capacity rigid solid/stranded wire		1-25 mm ²
Terminal screw		M5 (with slotted screw acc. to EN ISO 4757-Z2, PZ2)
Fastening torque of terminal screws		max. 2.4 Nm
Snap on fixing		tristable (on DIN rail acc. to EN 50022)
Finger proof		acc. to VBG4, ÖVE EN-6
Degree of protection (DIN VDE 0470)		
Surface mounted		IP20
Built-in behind panel		IP40
Contact position indicator		red / green
Electrical		
Rated voltage	U_n	255/440 V AC (Characteristic B, C), 240/415 V AC (Characteristic D) 60 V DC per pole
Rated current	I_n	Type B, C, D: 1, 2, 3, 4, 6, 10, 12, 13, 15, 16, 20, 25, 32, 40 A
Rated insulation voltage	U_i	440 V AC
Rated impulse withstand voltage	U_{imp}	4 kV (1.2/50) μ sec
Tripping characteristic		
Conventional non-tripping current		$I_{nt} = 1,13 I_n$
Conventional tripping current		$I_t = 1,45 I_n$
Reference temperature		40 °C
Temperature factor		0.4%/K
Instantaneous tripping current	I_{mt}	Type B: $3 I_n < I_{mt} = 5 I_n \cdot t (I_{mt}) < 0.1 \text{ sec}$ Type C: $5 I_n < I_{mt} = 10 I_n \cdot t (I_{mt}) < 0.1 \text{ sec}$ Type D: $10 I_n < I_{mt} = 20 I_n \cdot t (I_{mt}) < 0.1 \text{ sec}$
Rated ultimate short-circuit breaking capacity I_{cu} (IEC/EN 60947-2)		Type B 1-25 A: 25 kA, 32-40 A: 20 kA Type C 1-25 A: 25 kA, 32-40 A: 20 kA Type D 1p/1p+N/2p - 1-13 A: 25 kA, 15-20 A: 20 kA, 25-40 A: 15 kA 3p/3p+N/4p - 1-16 A: 25 kA, 20 A: 20 kA, 25-40 A: 15 kA
Rated service short-circuit breaking capacity I_{cs} (IEC/EN 60947-2)		for $I_{cu} = 25 \text{ kA} \rightarrow I_{cs} = 12.5 \text{ kA}$: 240/415 V AC; $I_{cu} = 15 \text{ kA}$: 255/440 V AC for $I_{cu} = 20 \text{ kA} \rightarrow I_{cs} = 10 \text{ kA}$: 240/415 V AC; $I_{cu} = 15 \text{ kA}$: 255/440 V AC for $I_{cu} = 15 \text{ kA} \rightarrow I_{cs} = 7.5 \text{ kA}$
Rated short-circuit breaking capacity I_{cn} (IEC/EN 60898-1)		Type B 1-25 A: 15 kA, 32-40 A: 10 kA Type C 1-25 A: 15 kA, 32-40 A: 10 kA Type D 1-16 A: 15 kA, 20-40 A: 10 kA
Selectivity class		3 (acc. to EN 60898)
Number of electrical operations		> 4.000 (IEC/EN 60898)
Number of mechanical operations		> 10,000 (IEC/EN 60947)
Climatic conditions		acc. to IEC 60068-2-30 (25..55°C / 90..95% RH)
Operating temperature range		-40°C up to +75°C
Storage- and transport temperature		-40°C up to +75°C

Connection diagram

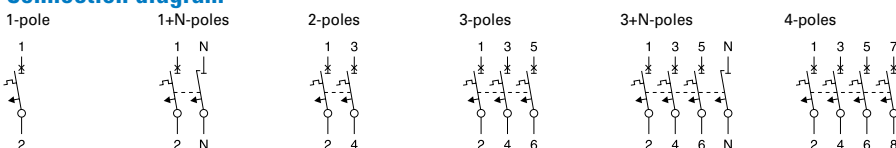

Dimensions (mm) FAZ-T

1-pole

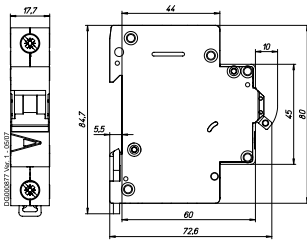

1+N-poles

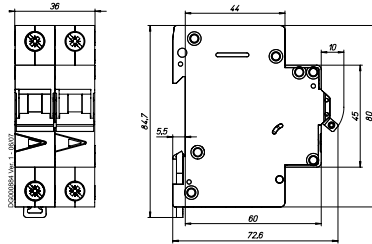

2-poles

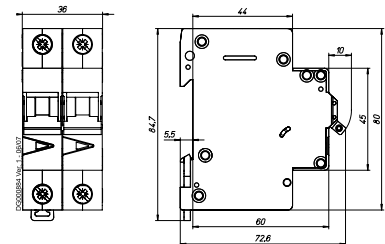

3-poles

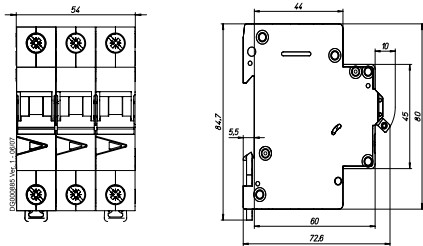

3+N-poles, 4-poles

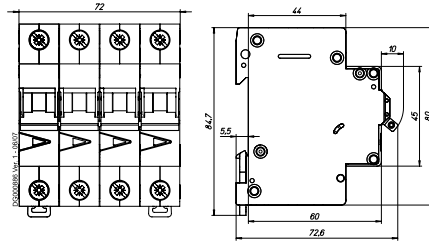

Tripping Characteristics FAZ-T

Characteristics B, C and D - EN60898

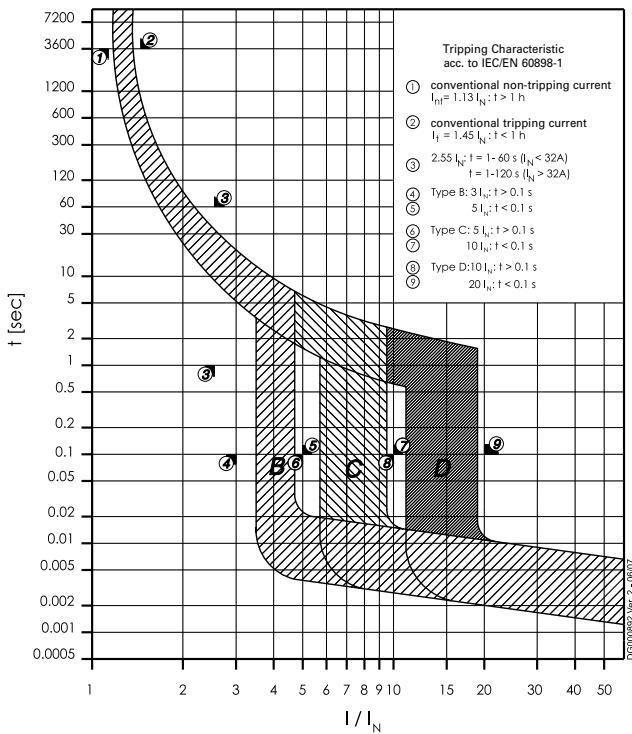

Power Loss at I_n FAZ-T (50/60 Hz)

Type B						
I_n [A]	1p P [W]	1pN P [W]	2p P [W]	3p P [W]	3pN* P [W]	4p P [W]
1	1.6	1.7	3.1	4.7	4.8	6.3
2	1.4	1.5	2.8	4.1	4.3	5.5
3	2.5	2.7	5.0	7.6	7.8	10.1
4	1.4	1.6	2.9	4.4	4.5	5.8
6	1.8	2.0	3.6	5.5	5.6	7.3
10	1.9	2.1	3.9	5.9	6.1	7.8
12	2.8	3.2	5.9	8.7	9.0	11.5
13	2.5	2.9	5.3	7.8	8.1	10.3
15	2.1	2.4	4.4	6.5	6.7	8.6
16	2.2	2.6	4.7	6.9	7.2	9.1
20	3.2	3.6	6.6	9.8	10.1	13.0
25	3.0	3.5	6.4	9.4	9.7	12.4
32	3.7	4.4	8.1	12.1	12.5	15.8
40	3.4	4.1	7.5	11.2	11.5	14.6

* symmetrical load

Type C						
I_n [A]	1p P [W]	1pN P [W]	2p P [W]	3p P [W]	3pN* P [W]	4p P [W]
1	1.6	1.7	3.1	4.7	4.8	6.3
2	1.4	1.5	2.8	4.1	4.3	5.5
3	1.2	1.3	2.4	3.6	3.7	4.8
4	1.4	1.6	2.9	4.4	4.5	5.8
6	1.5	1.6	2.9	4.4	4.6	5.9
10	1.5	1.7	3.0	4.6	4.7	6.1
12	2.1	2.4	4.4	6.5	6.8	8.6
13	2.5	2.9	5.3	7.8	8.1	10.3
15	2.1	2.4	4.4	6.5	6.7	8.6
16	2.2	2.6	4.7	6.9	7.2	9.1
20	3.2	3.6	6.6	9.8	10.1	13.0
25	3.0	3.5	6.4	9.4	9.7	12.4
32	3.7	4.4	8.1	12.1	12.5	15.8
40	3.4	4.1	7.5	11.2	11.5	14.6

* symmetrical load

Type D						
I_n [A]	1p P [W]	1pN P [W]	2p P [W]	3p P [W]	3pN* P [W]	4p P [W]
1	0.8	0.9	1.6	2.4	2.5	3.2
2	1.0	1.1	2.0	3.0	3.1	4.0
3	1.2	1.3	2.4	3.6	3.7	4.8
4	1.4	1.6	2.9	4.4	4.5	5.8
6	1.5	1.6	2.9	4.4	4.6	5.9
10	1.5	1.7	3.0	4.6	4.7	6.1
12	1.7	2.0	3.6	5.3	5.4	7.0
13	1.9	2.2	4.0	5.9	6.1	7.8
15	2.1	2.4	4.4	6.5	6.7	8.6
16	2.2	2.6	4.7	6.9	7.2	9.1
20	2.0	2.2	4.1	6.1	6.2	8.1
25	2.5	2.9	5.2	7.7	7.9	10.2
32	3.4	4.0	7.4	11.1	11.4	14.5
40	3.2	3.8	7.0	10.4	10.7	13.6

* symmetrical load

Influence of Ambient Temperature FAZ-T

On Load Carrying Capacity (temperature derating)

I_n [A]	Ambient temperature T [°C]																
	-40	-30	-20	-10	0	10	20	30	35	40	45	50	55	60	65	70	75
1	1.3	1.2	1.2	1.2	1.1	1.1	1	1	0.99	0.97	0.95	0.93	0.9	0.89	0.87	0.85	0.83
2	2.6	2.5	2.4	2.3	2.2	2.2	2.1	2	2	1.9	1.9	1.9	1.8	1.8	1.7	1.7	1.7
3	3.8	3.7	3.6	3.5	3.4	3.3	3.1	3	3	2.9	2.8	2.8	2.7	2.7	2.6	2.5	2.5
4	5.1	5	4.8	4.7	4.5	4.3	4.2	4	3.9	3.9	3.8	3.7	3.6	3.5	3.5	3.4	3.3
6	7.7	7.5	7.2	7	6.7	6.5	6.3	6	5.9	5.8	5.7	5.6	5.4	5.3	5.2	5.1	5
10	13	12	12	12	11	11	10	10	9.9	9.7	9.5	9.3	9	8.9	8.7	8.5	8.3
12	15	15	14	14	13	13	13	12	12	12	11	11	11	11	10	10	10
13	17	16	16	15	15	14	14	13	13	13	12	12	12	12	11	11	11
15	19	19	18	17	17	16	16	15	15	15	14	14	14	13	13	13	12
16	20	20	19	19	18	17	17	16	16	15	15	15	14	14	14	14	13
20	26	25	24	23	22	22	21	20	20	19	19	19	18	18	17	17	17
25	32	31	30	29	28	27	26	25	25	24	24	23	23	22	22	21	21
32	41	40	38	37	36	35	33	32	32	31	30	30	29	28	28	27	26
40	51	50	48	47	45	43	42	40	39	39	38	37	36	35	35	34	33

Maximum Let-Through Energy FAZ-T

Type B

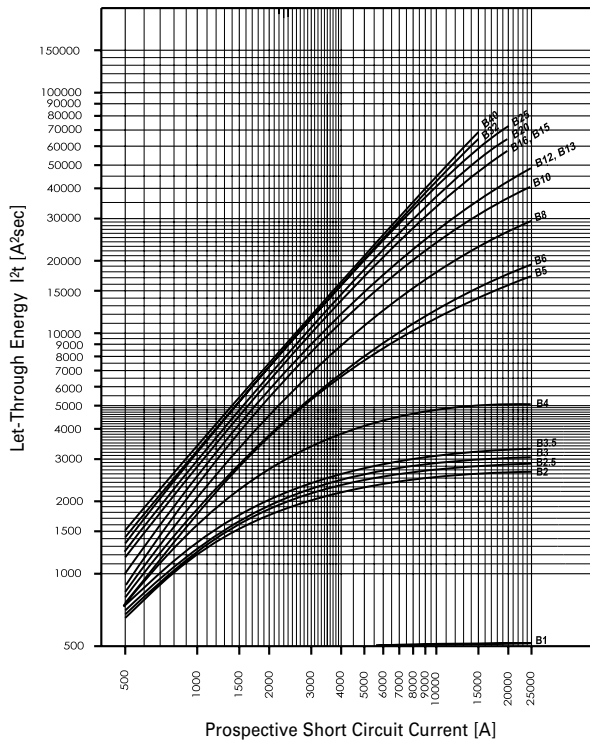

Type C

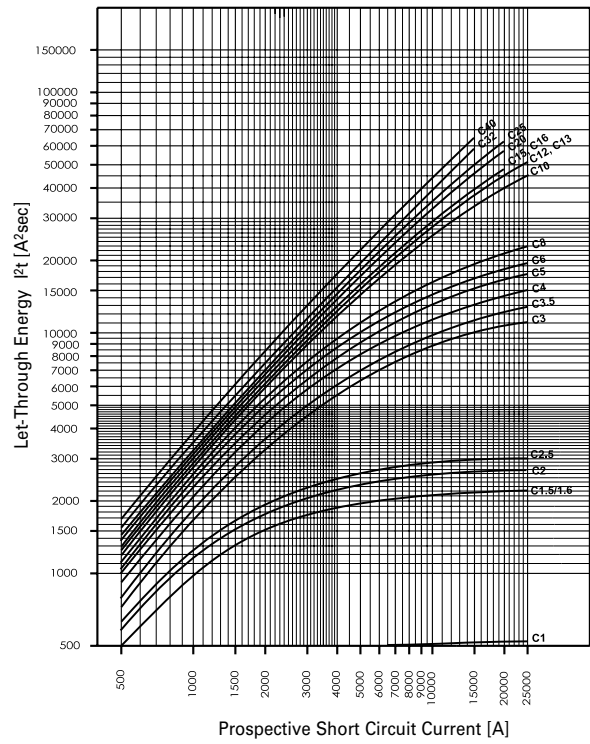

Type D

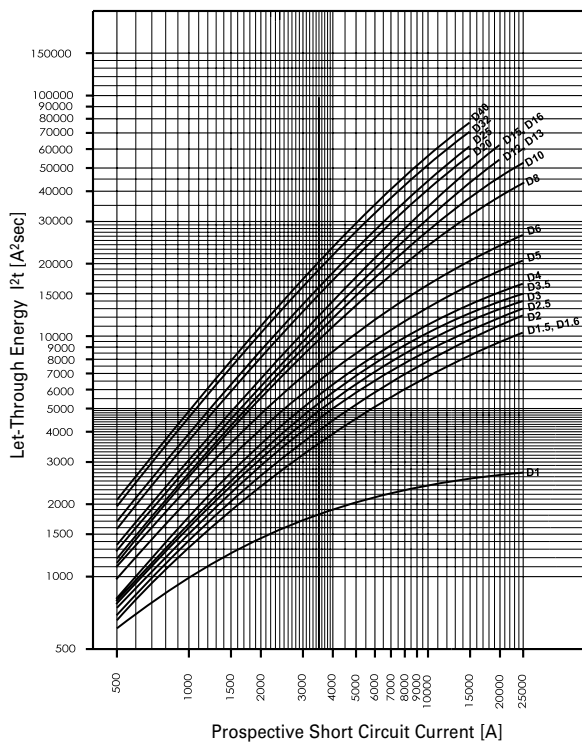

Maximum Let-Through Current FAZ-T

Type B

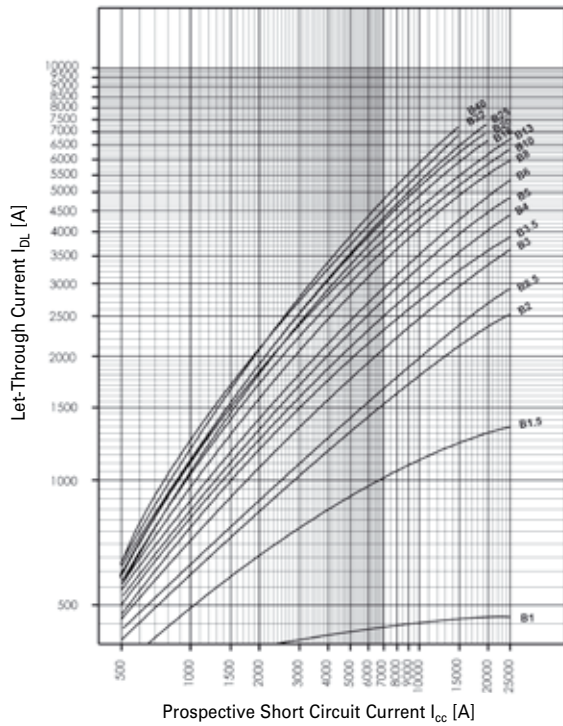

Type C

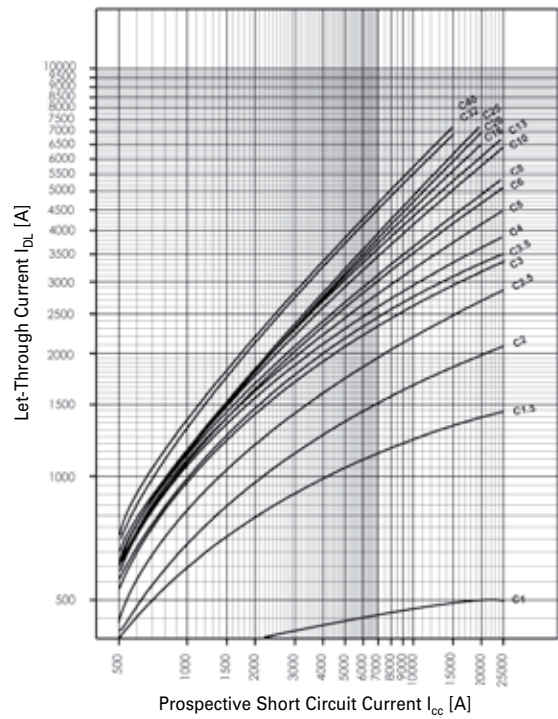

Type D

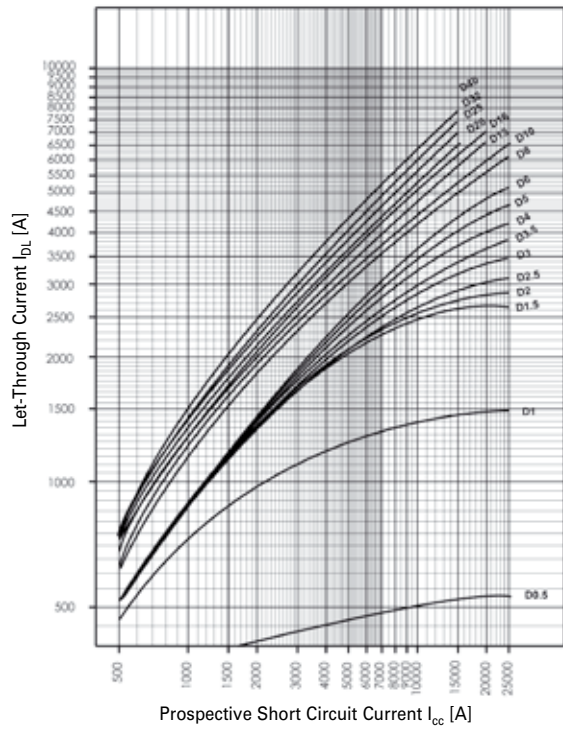

Influence of the Line Frequency FAZ-T

On the Instantaneous Tripping Current I_{MA}

	Line Frequency f [Hz]						
	16 ² / ₃	50	60	100	200	300	400
$I_{MA}(f)/I_{MA}(50\text{ Hz})$ [%]	91	100	101	106	115	134	141

The use of the products in networks with other frequencies than 50/60 Hz are in the customer's responsibility.

Load rating in case of circuit breakers arranged one next to the other FAZ-T

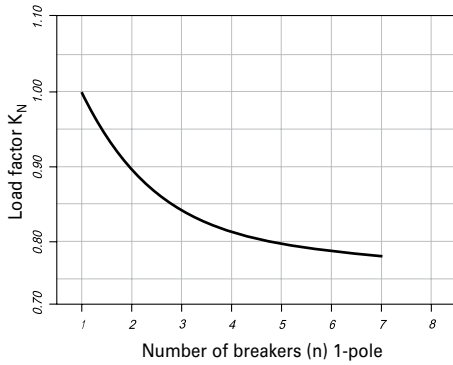

Derating table for FAZ/FAZ-T above 2000m sea level

60898	60947		
U_n 230/400V	U_n 230/400V		
B, C, D ≤63A	B, C ≤63A and D ≤40A	D50, D63	B, C, D ≤63A

Above sea level (m)	Overvoltage category	Disconnect function	I/I_n	I_{cn}	I_{cs}	I_{cu}		I_{cs}
m	x	x	x	kA	kA	kA	kA	kA
≤2000	III	yes	1	10	7.5	15	10	7.5
>2000-2500	II	no	0.93	6	6	10	6	6
>2500-3000	II	no	0.88	6	6	10	6	6
>3000-3500	II	no	0.83	6	6	10	6	6
>3500-4000	II	no	0.78	6	6	10	6	6

Eaton's electrical business is a global leader with deep regional application expertise in power distribution and circuit protection; power quality, backup power and energy storage; control and automation; life safety and security; structural solutions; and harsh and hazardous environment solutions. Through end-to-end services, channel and an integrated digital platform & insights Eaton is powering what matters across industries and around the world, helping customers solve their most critical electrical power management challenges.

For more information, visit [Eaton.com](https://www.eaton.com).



<http://id1.hu/eaton/xeffect-FAZ-T-kismegszakito>

Eaton Industries (Austria) GmbH
Scheydgasse 42
1210 Vienna
Austria

Eaton
EMEA Headquarters
Route de la Longeraie 7
1110 Morges, Switzerland

© 2022 Eaton
All Rights Reserved
Publication No. CA003035EN
Article number 304271-MK
February 2022

Changes to the products, to the information contained in this document, and to prices are reserved; as are errors and omissions. Only order confirmations and technical documentation by Eaton is binding. Photos and pictures also do not warrant a specific layout or functionality. Their use in whatever form is subject to prior approval by Eaton. The same applies to trademarks (especially Eaton, Moeller, and Cutler-Hammer). The Terms and Conditions of Eaton apply, as referenced on Eaton Internet pages and Eaton order confirmations.

Eaton is a registered trademark.

All other trademarks are property of their respective owners.

Follow us on social media to get the latest product and support information.

